

NEW WASTE APPLICATION

DO NOT SCALE THIS DRAWING

IMPORTANT
DRAWING TO BE READ IN
CONJUNCTION WITH STRUCTURAL
ENGINEER'S DRAWINGS &
INFORMATION

PLEASE NOTE
This drawing and the works depicted are the copyright of Design and Planning Associates Ltd (DPA), and may only be reproduced with written permission. No alteration to the design or specification is permitted without the written approval of DPA.

All dimensions and levels depicted are subject to checking and verified on site prior to construction. Any discrepancies are to be immediately notified to DPA. Figure dimensions to be used only.

The information contained in this drawing must only be used at the named location. The location of any services indicated on this drawing are approximate only and must be checked on site by the main contractor before commencing works.

Client/Contractor is to be responsible for locating any underground services.

CDM Regulations - Where applicable the designers hazard identification sheets to be read in conjunction with all consultants drawings, specifications and existing record drawings. It is considered that a competent contractor will be able to identify hazards associated with the project from the information above, and take the necessary precautions to deal with any risks to health and safety.
CDM - for the avoidance of doubt the Principal Contractor is reminded that he is fully and solely responsible for the day to day management of site safety.

Compliance with the construction design and management regulations (CDM) is the sole responsibility of the client unless we are otherwise instructed in writing.

CONSTRUCTION NOTES GENERALLY:
Notwithstanding anything contained in this document or any other document forming part of the basis of the works every aspect of the work/installation is to comply with all requirements and all recommendations of all relevant Associations, Manufacturers, BPE Codes, British Standards, Codes of Practice, Building Regulations, Dye Laws, Acts, Regulations, Planning Authority, Environmental Health Department, Fire Authorities, Water Authorities, Gas Authority, Electricity Authority, Institute of Heating and Ventilating Engineers and IEE Regulations.

NOTES:
FOR FULL DETAILS PLEASE READ THIS DRAWING IN CONJUNCTION WITH THE LATEST REVISION OF THE FOLLOWING DPA LTD DRAWINGS:

- BR-10 G.A FLOOR PLANS - OFFICES
- BR-11 G.A FLOOR PLANS - DRYING ROOM
- BR-12 GROUND FLOOR G.A FLOOR PLAN - OVERALL
- BR-13 F.F FLOOR PLAN G.A FLOOR PLAN - OVERALL
- BR-14 PARTITION FLOOR PLANS - OFFICES
- BR-18 GROUND FLOOR FIRE PLAN - OVERALL
- BR-19 FIRST FLOOR FIRE PLAN - OVERALL
- BR-30 SECTION A-A (1:20)
- BR-90 CONSTRUCTION & B. REGS NOTES

PLEASE NOTE: IT IS THE CONTRACTOR'S RESPONSIBILITY TO CHECK ALL DIMENSIONS ON SITE. DIMENSIONS MUST NOT BE SCALED FROM THIS DRAWING. ANY DISCREPANCIES BETWEEN PROJECT DRAWINGS OR DOCUMENTS TO BE BROUGHT TO THE IMMEDIATE ATTENTION OF THE ARCHITECT IN WRITING.

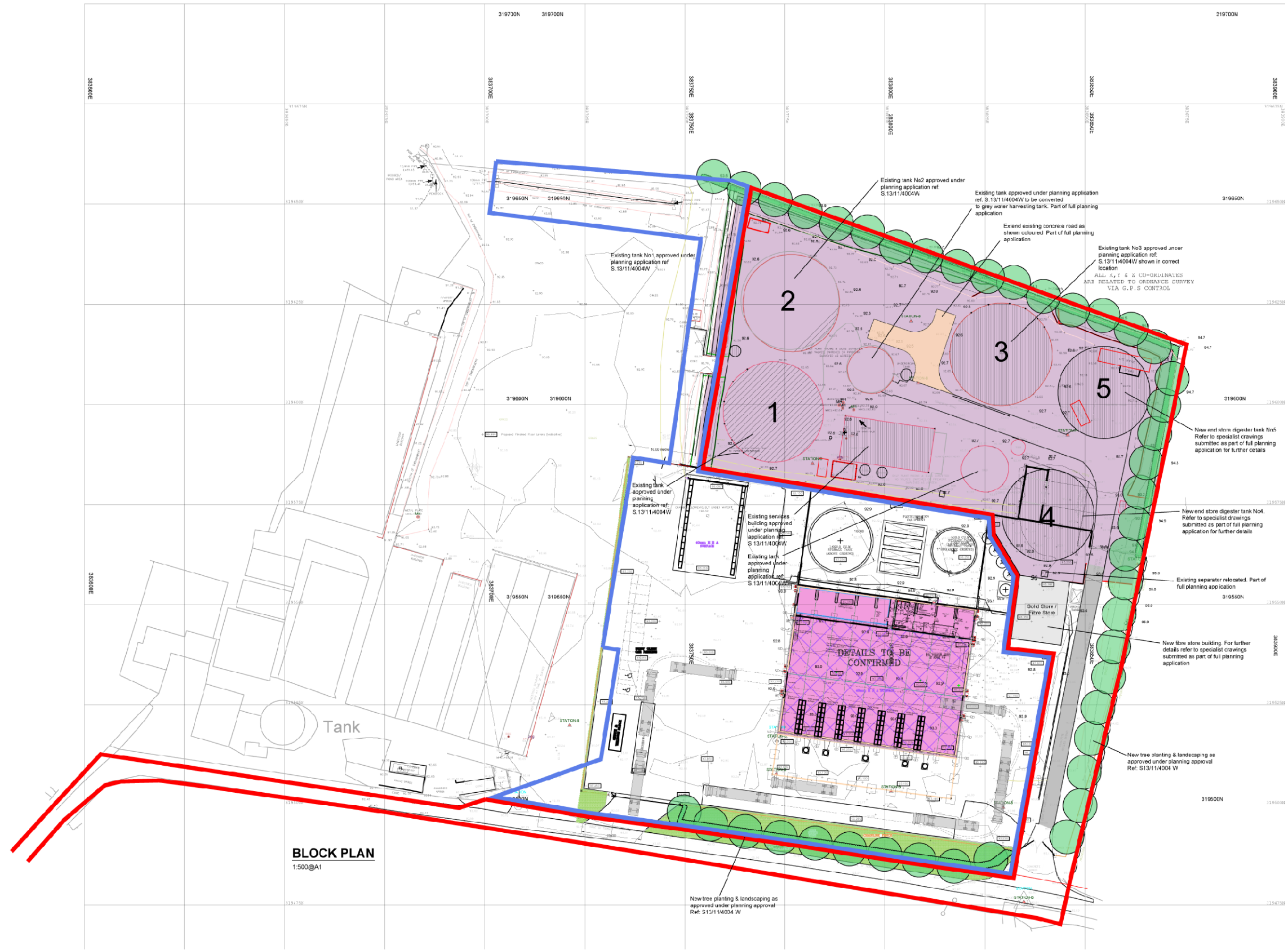

Plan 3 - Site Layout
(Application Ref. S.20/01/4004 W)



Lower Reule Bioenergy Ltd. a) Application to vary (not comply with) Condition 1 (Approved documents and plans) of planning permission ref. S.16/05/4004 W relating to: amendments to the location of the weighbridge and office; reduction of the landscape area (trees and hedges retained as approved); the increase of the 'lean to' size; inclusion of pasteurising equipment; relocation of liquid storage tanks; relocation of odour control (now referenced bio filter); relocation of post pasteurization tank and, amendments to the northern elevation of the food de-packaging facility ancillary to the adjacent Anaerobic Digestion plant ref S.19/08/4004 W and b) Application to consolidate the existing Anaerobic Digestion (AD) facility / biogas facility (planning permission Ref. S.13/11/4004 W) and amendments to the layout including: relocation of separator; new concrete road within the site; erection of new building to replace and relocate the existing store for separated digestate fibre (planning permission Ref. S.15/01/4004 W); and erection of two end storage tanks for liquid digestate to replace the lagoons previously used ref. S.20/01/4004 W, Lower Reule Bioenergy Ltd, Brookfield Farm, Cowley, Gnosall, Stafford.

BLOCK PLAN
1:500@A1

BLOCK PLAN

| | |
|-------------------------------|--|
| Date : 17/03/20 | Scale : Not to Scale |
| O.S. Grid Ref : SJ.837 195 | Ref : S.19/08/4004 W & S.20/01/4004 W |